



Eco NEXUS®

OPERATOR INSTRUCTION LEAFLET

IMPORTANT NOTE: ENSURE THAT ALL RELEVANT PERSONNEL READ THESE INSTRUCTIONS PRIOR TO USE

OPENING YOUR ECO NEXUS

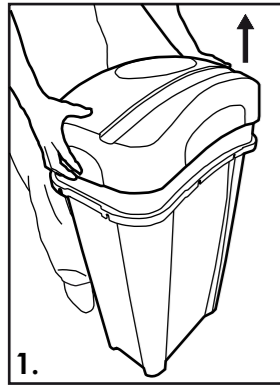

1. Using finger lip on both sides of lid, lift lid upwards and off body of bin.

SECURING SACK IN POSITION



2. Install correct size sack (approx. 406mm x 727mm x 1093mm for both bin sizes, available from Glasdon) by stretching over upper part of body.

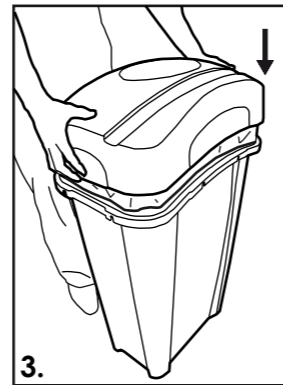

3. Place lid back onto body ensuring that sack is neatly secured underneath lid.

EMPTYING YOUR ECO NEXUS



4. Remove lid (as detailed above)

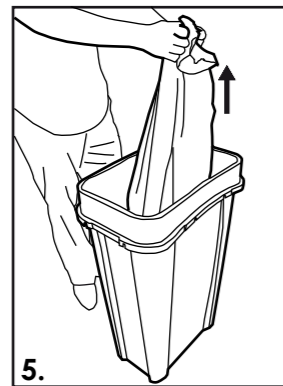

5. Release sack from body and lift out of bin.

UNLOCKING YOUR ECO NEXUS

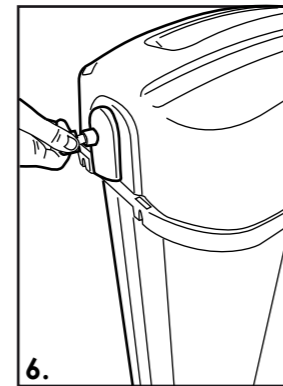

6. The confidential paper model comes complete with push lock. Using key provided turn in lock to open.

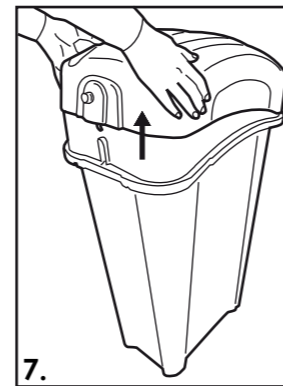

7. Lift push lock end of lid upwards followed by opposite end. Lift lid off bin completely.

LOCKING YOUR ECO NEXUS

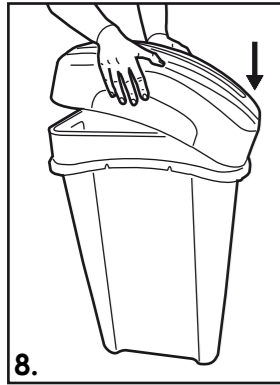

8. Firstly, place end of lid opposite to push lock onto bin body ensuring that pin locates into slot within body (See above.)

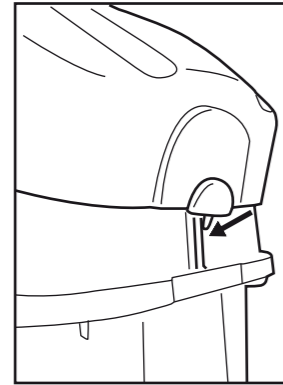

9. Push lock end of lid downwards so that front pin locates into slot within body.

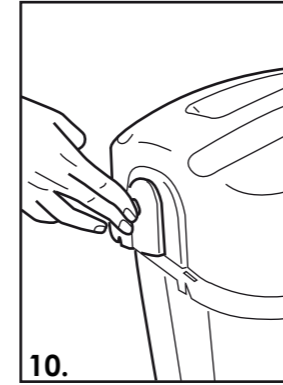

10. Finally, push lock centre inwards to lock bin.

ATTACHING A SIGN KIT TO YOUR ECO NEXUS



11. Push sign carrier into slots provided on either front or side of bin.

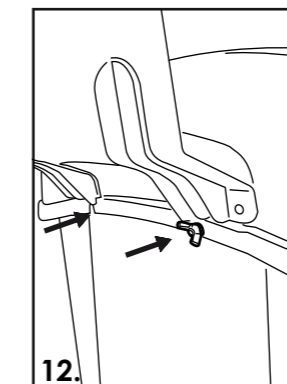

12. Push 1 off screw with washer provided through each hole in lip of body so that screw is protruding outside of bin. Place a second washer over each screw and secure in position with wing nuts provided.

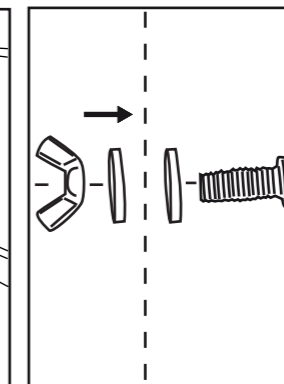

INSERTING A4 SIGN

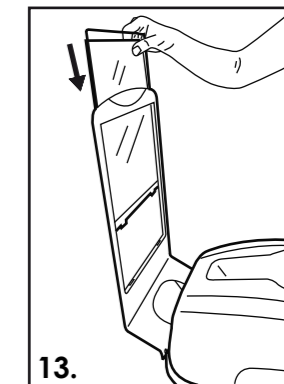

13. Place A4 sign behind clear polycarbonate sheet and slide into sign carrier so that the lugs locate in the holes along the bottom of the sign carrier.

EMPTYING/REPLACING CUPBANK RESERVOIR

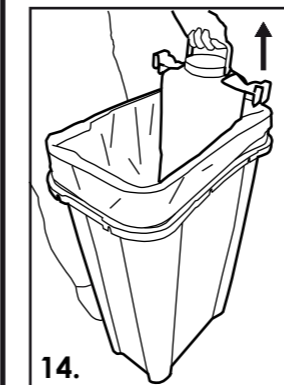

14. Remove lid (see fig.1). Lift reservoir out of body using handle and tip contents away.

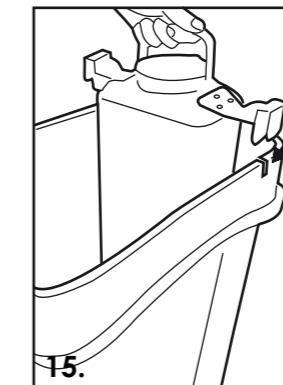

15. To replace reservoir, locate reservoir holders into slots on rim of bin body. Replace lid ensuring funnel is located over reservoir.

ATTACHING WHEELS TO YOUR ECO NEXUS

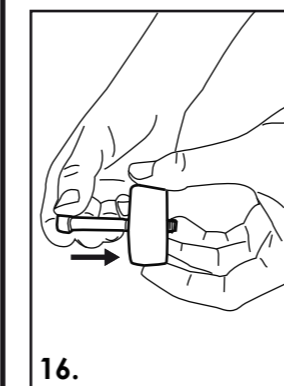

16. From kit provided, place 1 off screw through a wheel.

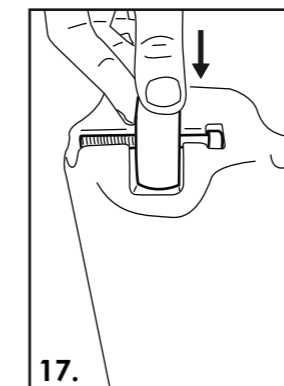

17. Turn bin body upside down and click screw and wheel into moulded slot. Repeat with second wheel.

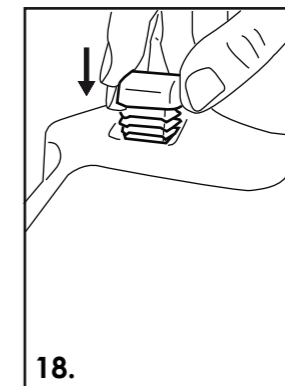

18. Push 2 off socket caps into moulded recesses opposite wheels.



19. Using lip on body as a handle, tilt bin onto wheels to manoeuvre bin around.



AND ECO NEXUS® ARE TRADEMARKS OF GLASDON GROUP OR ITS SUBSIDIARIES IN THE U.K. AND OTHER COUNTRIES



Glasdon

Glasdon U.K. Limited

Preston New Road

BLACKPOOL

Lancashire FY4 4UL

Tel: 01253 600410

Fax: 01253 792558

email: sales@glasdon-uk.co.uk

web: www.glasdon.com

Issue 2 July 2011 C000/0383

© Copyright July 2011

Glasdon UK Ltd reserve the right to alter specifications without prior notice.